



INSTALLATION GUIDE

KENWORTH W900 UNDER-CAB LED LIGHT KIT

IMPORTANT! No two installation scenarios are the same. Accent lighting is highly subjective. Not everyone shares the same lighting or installation quality goals. Some folks are OK with twisting wires together, others want to solder and heat shrink them. Some folks are OK with running wires where they may be seen or unprotected to save money/time, others want a tidy, clean install so they wrap plastic split-loom around all exposed cables. Some folks are OK with mounting their LED strips to whatever surface they can find, others want to take the time necessary to build out appropriate mounting surfaces to provide the best lighting effect on their vehicle and maximize the longevity of their lighting system. The point is it's not possible to provide all the materials necessary for all installation scenarios on all types of vehicles to meet everyone's quality goals. Our light kits provide the essential components needed for a high-quality, functioning lighting system. Installation of our light kit to your specific vehicle will however likely require additional items to make it look, fit and work the way you want. This is particularly the case with electrical wiring, switching functionality and mounting surfaces for the LED strips. We have created a list of additional items you may need. Here's the link: <https://www.boogeylights.com/other-items-you-might-need/> . While we offer them for sale you can also find these items locally. We urge you to review this information before starting your install.

BENCH TEST YOUR LIGHTING COMPONENTS FIRST!

We know this takes a few extra minutes, but we **STRONGLY** suggest you bench test your lights AND your controller / switches on a table before doing anything further. Test all of them. While we test every light strip and controller before shipping, bench testing your lights will eliminate the possibility of any problems with the lights or controller before mounting. It also lets you know everything is working properly. Also, the process of bench testing gives you an opportunity to understand the wiring system without interference from other wires, connectors and cables. You can use any 12vdc battery to do this (e.g. car battery, motorcycle battery, lawn tractor battery or 12vdc power supply). If you're not sure how to bench test, download this pdf: <https://docs.boogeylights.net/?wpdmdl=1305> . Bench testing takes an extra 10 or 15 minutes. It's simple to do and can potentially save you hours of time and frustration down the road.

Did we mention the importance of bench testing every LED strip and controller first?

THIS IS A GUIDE. NOT A HOW-TO. It's simply not possible to provide detailed instructions for all installation scenarios. Far too many variables. The information in this document is intended to be used as a guide. It is not a detailed step-by-step how-to installation manual. We do not spell out every single step along the way. We cover the essential steps related to installing this kit. Beyond that we assume the installer has the skills, knowledge and tools necessary to do the work using the information we provide as a guide. You may need to vary your installation and/or make adjustments based on your vehicle. This is particularly the case with led strip mounting locations, electrical wire routing, electrical connections, electrical load sizing and switching. If you're unsure about how to do the installation – particularly the electrical components – we urge you to seek assistance from someone who has those skills.

YOU MUST HAVE AN UNDERSTANDING OF 12V POWER. An essential skill with installation of any Boogey Lights LED products is knowing how to correctly wire the product to a 12vdc circuit. This includes understanding the importance of having a properly sized fuse at the power source, polarity, how to properly seal an electrical connection, using properly sized wire gauge for the load, measuring voltage and measuring the additional amperage draw you're adding. If you are uncertain or unfamiliar with any of these concepts, we urge you to ask someone who has the knowledge to assist you. Electricity is unforgiving.

MOUNTING SURFACE. How and where you mount your LED strips will for the most part determine the longevity of your lighting system. If you mount the LED strips to smooth, clean, continuous, straight, flat surfaces as we recommend, you can expect your lighting system to last for many years

SECURE THE POWER LEADS. Make sure the power lead wire that connects to one end of the LED strip is firmly secured to the boat. Do not allow that power lead to move or flex at the point where it attaches to the LED strip. If you do, it will fail prematurely and is not covered under warranty.

INSTALLATION TIME. We suggest allocating 2 to 3 hours to properly install this under-cab light kit.

POWER LEADS. All of the power leads coming from the LED strips will need to be routed back to your power source/switch/controller which is usually mounted near the battery bank. We typically will mount the led controller in the driver's side storage box (aka 'jockey box'). If you're installing this kit along with another one of our light kits, you can usually merge the wiring together. It's important these power lead be secured (especially at the point where the power lead attaches to the LED strip) and wrapped in split loom to prevent chafing.

Mounting & Placement Locations | Planning Your Install

All 6 of the LED strips in this kit are built on our LOW PROFILE LED strips. Each LED strip has a 10' power lead attached to them. In total there are 6 different mounting locations in this kit and all of the power leads need to be carefully run. See diagram on next page for placement.

For power, you'll need access to the driver's side steps to access the batteries. Also, if you're installing an LED controller, the LED controller can be mounted in either the driver's side storage box or the passenger's. We prefer to use the driver's side as it is closest to the battery bank. While either location will work, be aware if you mount the controller in the passenger's side, you'll need to extend the positive battery cable a little further than if you mounted the controller in the driver's side storage. The 12vdc + power going to the LED Controller should connect directly to the 12vdc+ terminal on your truck's battery bank. You can connect the ground wire on the LED controller to any metal part of the chassis. Regardless of which side bay you use, you will need to drill a hole in the floor of that box to connect power to the battery box, led wires and antenna.

We recommend connecting all LED strips in similar locations together and then running one feeder cable back to the LED controller or switching mechanism you're using. Doing so reduces the total number of power leads coming back to the LED controller. We will typically connect the following LED segments together – creating 2 groups of led strips - and then use a single feeder cable to connect each of those LED groups back to the controller or switching mechanism you're using: A B C + D E F. We strongly recommend planning out your install on paper first. Be sure to wrap all power leads in split-loom which is also included and then secure them to the truck using zip ties.

LED PLACEMENT

These are the LED placement locations we used for this kit. It's important to follow this placement pattern to ensure the LED strips are protected. Mounting them in any other way voids warranty. Note that we provide actual photos of some of the placement locations at the end of this guide. Refer to the below lettered diagram for LED strip placement.

Note that two of the strips (A and D) require the building of a Z-BAR channel to mount them under the driver's and passenger's side door. You do this using the supplied plastic L channel and riveting two L channel pieces together so they form a 'Z'.

These two LED strips (A and D) also require the addition of a quick-disconnect connector which is supplied. This is because the Z Bar and the LED strips are mounted to the chrome flashing that is bolted to the bottom of each door to achieve the step lighting. See photos at the end of this guide for a better idea of how they're mounted.

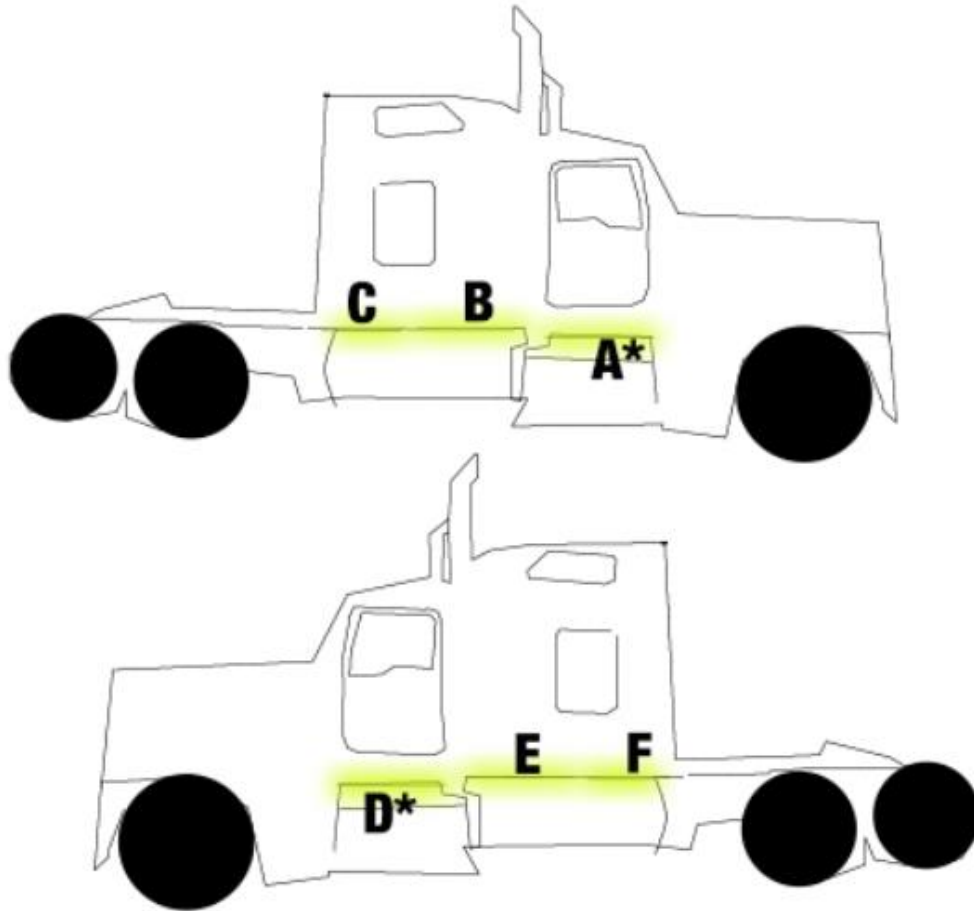

* Indicates the LED strip is mounted on plastic Z bar channel.

- A = 34" LED strip w/10' power lead. Mounted to with 36" Z-BAR channel to bottom of door flashing. This LED strip has a quick-disconnect connector to allow for servicing of the door flashing without damaging the LEDs.
- B = 31" LED strip w/10' power lead mounted under the sleeper.
- C = 12" LED strip w/10' power lead mounted under the sleeper.
- D = 37" LED strip w/10' power lead. Mounted to with 39" Z-BAR channel to bottom of door flashing. This LED strip has a quick-disconnect connector to allow for servicing of the door flashing without damaging the LEDs.
- E = 31" LED strip w/10' power lead mounted under the sleeper.
- F = 12" LED strip w/10' power lead mounted under the sleeper.

Mounting Info

Black Plastic “L” Channel and Z-Bar Creation. We like to use rivets when connecting these to the truck’s body because the LED strip can easily be mounted on top of the flat side of the rivet.

Both the drivers and passengers side door LED strips are mounted on a Z-BAR channel. To create this Z-BAR mounting platform use two L channels and rivet them together. See photo at the end of this guide showing how this is done.

Why use a Z Bar instead of just mounting the LED strip on the bottom of the chrome flashing? Because we never want the LEDs to be seen directly. If you were to mount the A and D LED strips on the bottom of the chrome flashing, drivers on both sides of the truck would easily see the LEDs. They will be distracting and potentially blinding; plus, it just looks bad. The goal is to only see the GLOW from the LEDs, not the LEDs themselves. Super important to use the Z Bar mounting method as shown to hide the LED strip up behind the chrome flashing.

Quick Disconnects

We include 2 pairs of quick disconnect connectors to be used for mounting LED Strips A and D. The type of quick disconnect will vary based on the type of LED strip you ordered. We include a wiring diagram of how to add these connectors to your install further on in this guide.



If you purchased a kit without an LED Controller or switch we do not include any switching devices with the kit. We assume you already have a switch available in your truck or will be installing another switch of some type. Regardless of how you decide to switch your single color LEDs, be mindful of the amperage that adding 231 tri-chip LEDs (at least) will draw. If you're considering adding these LEDs to an existing circuit (e.g. with your existing marker or running lights) we strongly suggest using a relay vs simply tapping into the existing circuit. This is especially important on newer trucks where the LCM will likely throw an error when you add more LEDs to the system.

MOUNTING THE LED STRIPS

Follow these steps for mounting your LED strips:

- The area where you are mounting the LEDs has to be clean: free of all dirt, oil or anything that might affect the LED from sticking. You only get one opportunity to mount the LEDs so it's critical the area be prepared properly.
- Use rubbing alcohol to clean the area where you are going to mount the LED strip. Be sure to let the alcohol dry completely before proceeding to the next step. (Note: Do not use acetone or similar cleaner).

If the area is especially greasy, you'll need to clean it with a degreaser or similar solvent. If you do, be sure to use rubbing alcohol on the surface next to completely remove any left-over residue from the degreaser.

- Next, use the 3M Adhesion Promoter supplied with your kit to "paint" on the promoter where you are going to mount the LED strip. ***This is an important step. Do not bypass.*** Allow the promoter to dry for 60-90 seconds.
- Peel off the red backing tape that protects the 3M adhesive tape on your LED strip. Be careful not to let the tape touch anything. The 3M backing tape on these LED strips are one-use only. They cannot be reused.

Carefully push the LED strip to the area you have prepared. You will want to apply only enough pressure to the strip to make sure it is firmly mounted. *You only get one opportunity to do this.* Once the LED strip touches a properly prepared surface that has been promoted, that LED strip will be very difficult to remove. Moreover, if you do remove the LED strip, the strip cannot be used again without adding another layer of 3M adhesive tape to the back. DO NOT press too hard as too much pressure can damage the LEDs and connecting wires in the strip. Also, do not pull, stretch or twist the LED strip. Too much tension on the strip will also damage the LEDs such that some of the LEDs in the strip will not illuminate. The strip must be mounted flat against a single continuous mounting surface, in a straight line. Really important that the ENTIRE STRIP be stuck to the mounting surface and that you NOT attempt to span across multiple mounting surfaces.

Do NOT bend the LED strip in a radius of less than 2 inches.



Do NOT bend the LED strip on a horizontal plane.



QUICK DISCONNECT CONNECTOR WIRING

Here's a photo showing how to use the 1/8" and 1/2" heat shrink to connect and seal the feeder cable connections to the power leads of LED Strips A and D. Tightly twist the copper wires together. Important that none of the copper wire strands poke through the heat shrink. Make sure they're all laying down (and not pointing outward). Then, slide the 1/8" heat shrink over the connection and heat shrink that connection. Repeat for the other 3 (or 1 if single color LEDs). When those connections have been made, slide the 1/2" heat shrink on top of the bundle and heat shrink. For the 1/8" heat shrink you only need about an inch (1") or 1.25" of heat shrink to seal each connection. Use 2 or 2.5 inches of the 1/2" heat shrink to cover the bundle.

NOTE: There are two sets of quick-disconnect connectors in this kit. One for the driver's side. One for the passenger's. They're used on LED strips A and D.

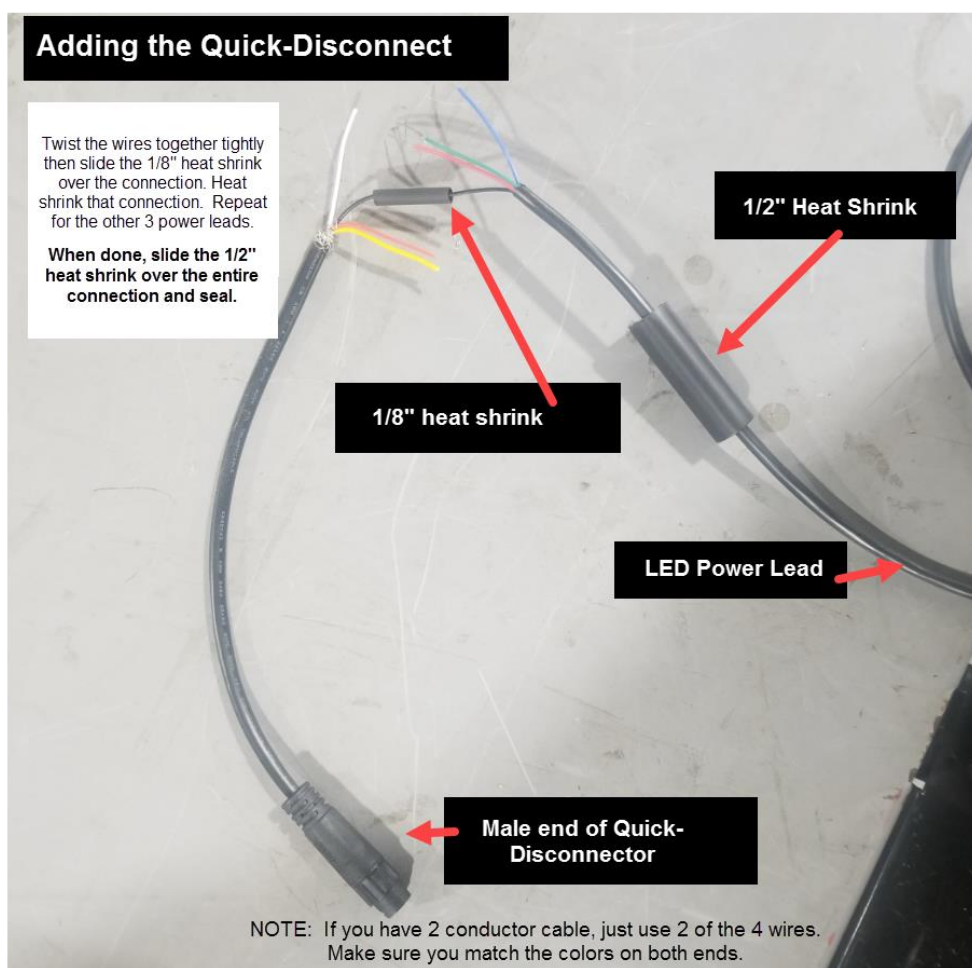

WIRING DIAGRAMS & POWER CONSIDERATIONS

This kit will include additional documentation for the color configuration you purchased including a wiring diagram. Please review carefully. Please review carefully. An essential skill with installation of any Boogey Lights LED product is knowing how to correctly wire the product to a 12vdc circuit. This includes understanding the importance of having a properly sized fuse at the power source, polarity, how to properly seal an electrical connection, using properly sized wire gauge for the load, measuring voltage and measuring the additional amperage draw you're adding. If you are uncertain or unfamiliar with any of these concepts, we urge you to ask someone who has the knowledge to assist you.

Electricity is unforgiving.

Be mindful of the amount of amperage you're drawing through your lighting circuit and to not exceed the circuit component limitations. We have included an amperage chart to give you a general idea of amperage draw but be aware that the amount of power (amps) you're pulling through the circuit will vary based on a combination of three factors: 1) The number of LEDs in the circuit, 2) the amount of copper wire in the circuit and 3) the input voltage to the circuit. The amperage ratings for our switches, controllers and LEDs assume 12.5 vdc input or less. If you're going to be driving with your Boogey Lights on, be aware that the input voltage will absolutely increase when the engine is on as RPMs increase. It's not unusual for an alternator to charge the batteries at a rate of 13.5 to 14.5 vdc depending upon the vehicle. Increasing the input voltage to the LED Controller/LEDs will also increase the amperage draw of those LEDs because they'll burn brighter. For example, we've seen circuits that draw 17 amps when the engine is off and the input voltage is 12.5vdc but jump up to drawing 24 amps when the engine is on and RPMs increased. This is because the input voltage jumps to 14vdc when the engine is running. If your circuit is only sized for 20 amps but the system requires 24 amps while running, you're going to have a problem.

Generally speaking, you don't have to be concerned about this issue if you're not within 60% or more of the collective max amperage rating for the components in your circuit. **If however you're at or above that 60% rated load, we strongly suggest measuring actual amperage drawn for your installation to make sure it's fused and wired appropriately given the highest possible amperage draw when the alternator is charging the system at typical operating RPMs.** If you have an over-voltage situation, there are a couple of solutions:

- 1) install a voltage regulator that will limit the input voltage going to the lights to 12.5 vdc regardless of the alternator output voltage. We sell them. They can also be purchased on Amazon/EBay.
- 2) install a second fuse/relay circuit and balance the LED load between those two circuits. Doing so will effectively cut the load by 50% per circuit. This is our preferred solution when possible.

INSTALLATION PHOTOS

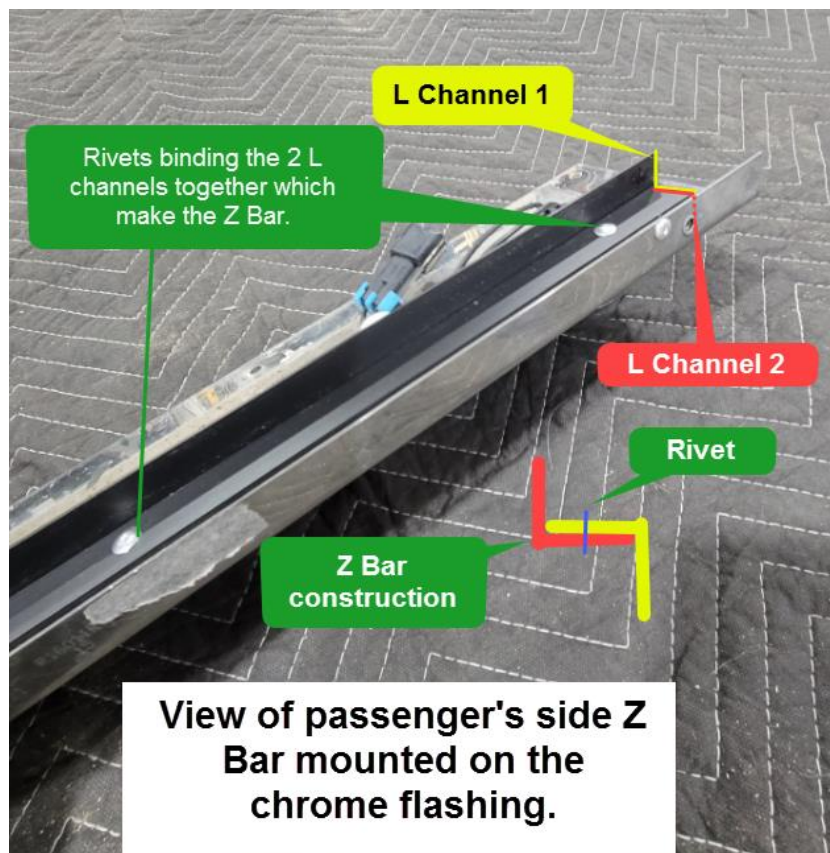
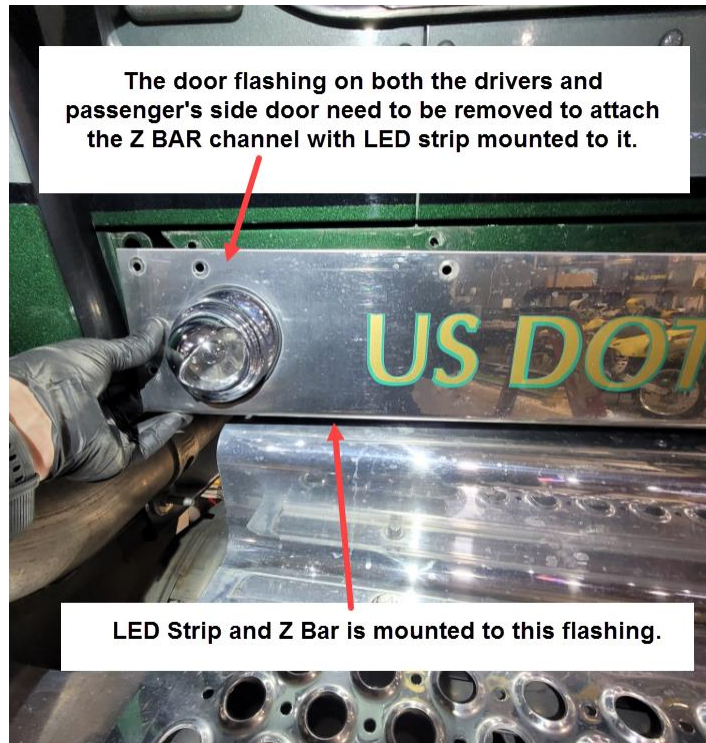

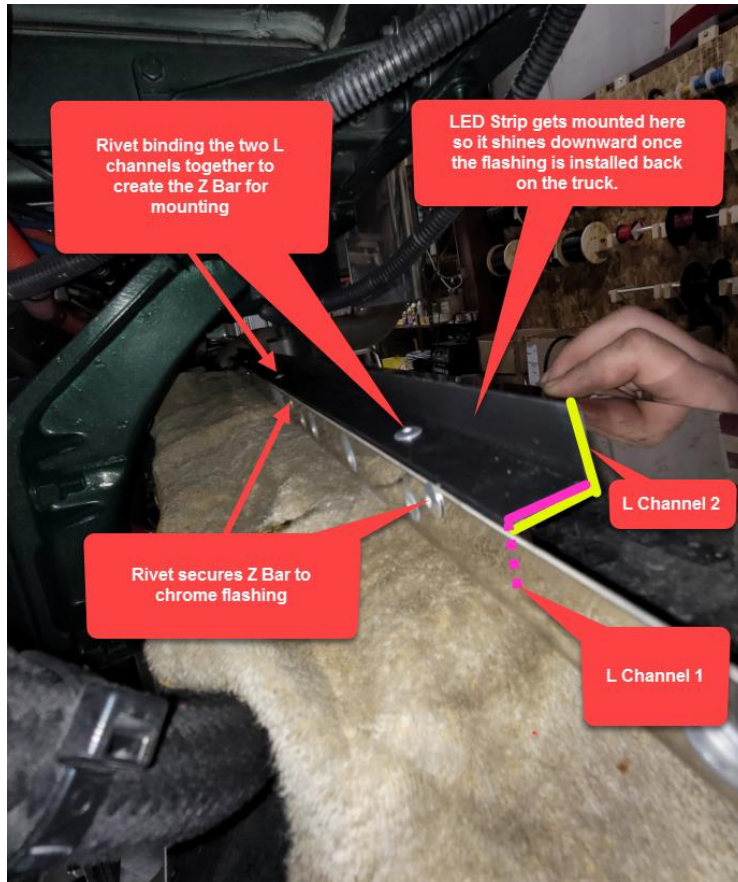



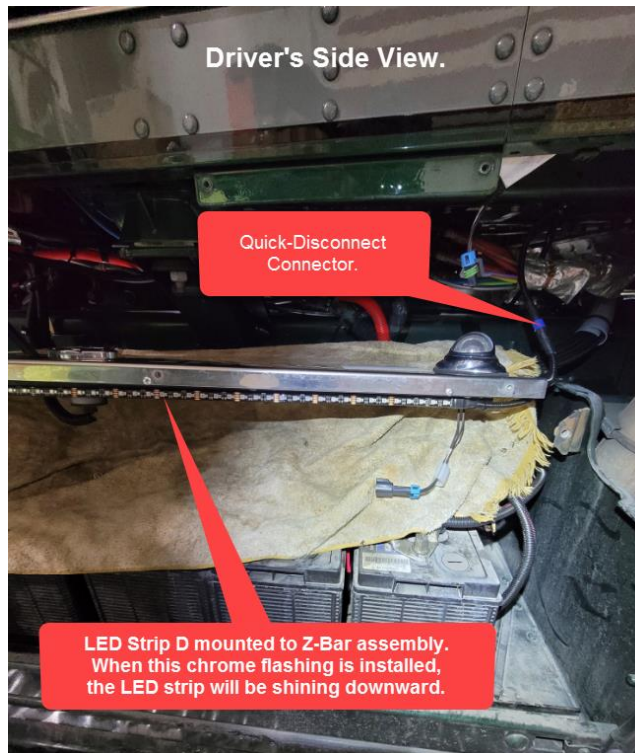

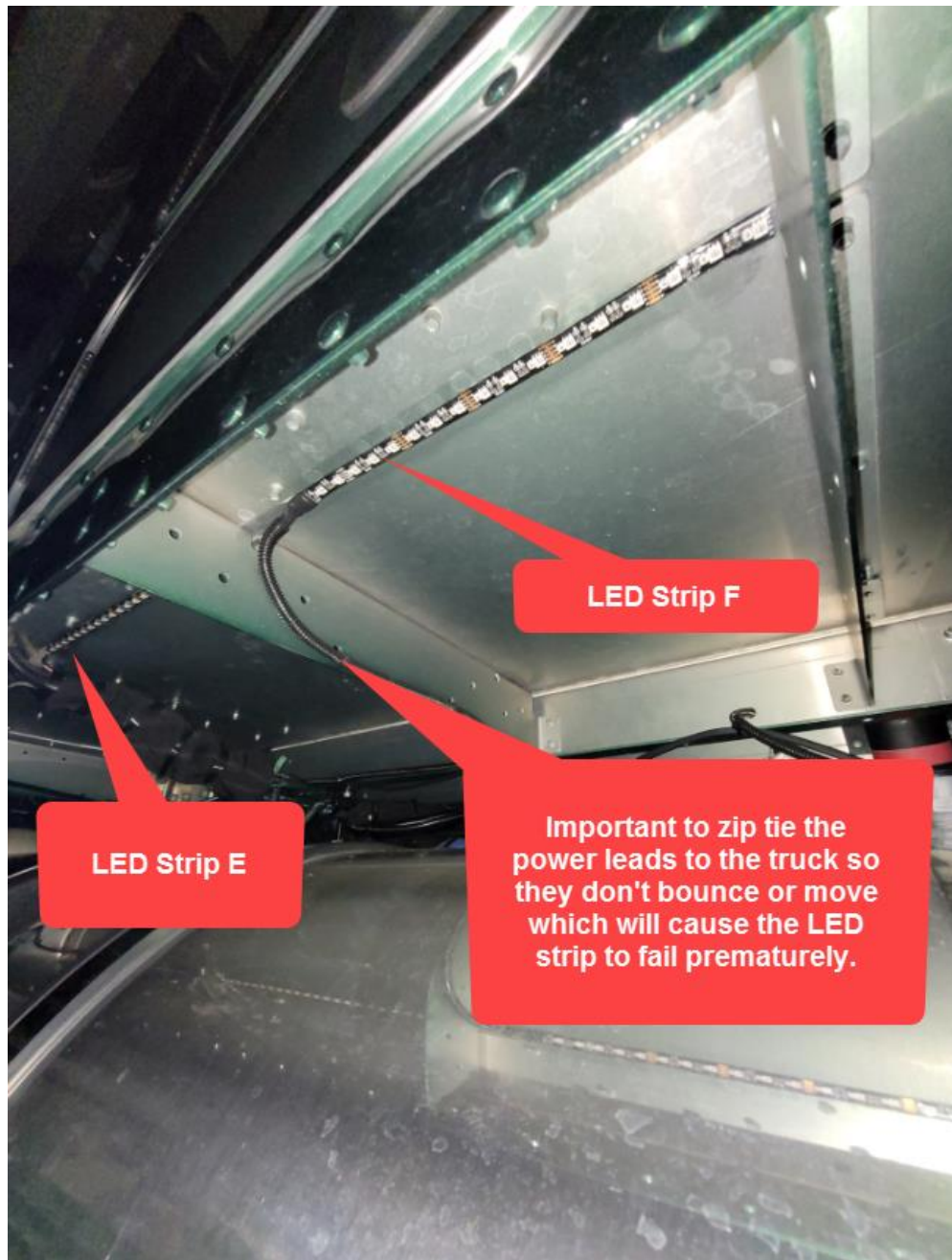

Additional Resources

- How to Videos: <https://www.boogeylights.com/how-to-videos/>
- Product Page: <https://www.boogeylights.com/kenworth-w900-led-accent-light-kit/>
- Troubleshooting: <https://www.boogeylights.com/trouble-shooting-guide/>
- Installation Resources: <https://www.boogeylights.com/installation-resources/>
- How to Bench Test: <https://docs.boogeylights.net/?wpdmdl=1305>
- Amperage Data: <https://docs.boogeylights.net/?wpdmdl=1137>
- GEN2 LED Controller Wiring Diagrams + Operating Info: <https://docs.boogeylights.net/?wpdmdl=1163>
- GEN2 RF Wireless Remote Operating Info: <https://docs.boogeylights.net/?wpdmdl=1164>
- GEN2 Bluetooth APP Operating Info: <https://docs.boogeylights.net/?wpdmdl=1169>
- GEN2 Bluetooth APP Quick-Start: <https://docs.boogeylights.net/?wpdmdl=1167>

Support

- Phone: 800.847.1359 (M-F, 9-6 Eastern)
- Text: 859.955.8155
- Open a Support Ticket: <https://www.boogeylights.com/email-us/>
- Online: 24/7 resources at <https://www.boogeylights.com/installation-resources/>
- How to Make a Warranty Claim: <https://www.boogeylights.com/make-a-warranty-claim/>

Warranty

The Boogey Lights® warranty requires an original sales receipt from Boogey Lights or an authorized dealer. It covers product replacement only, not labor or other costs. Register your purchase at: <https://www.boogeylights.com/warranty-registration/>. Full details: <https://www.boogeylights.com/warranty/>.