



INSTALLATION GUIDE

VOLVO VNL REAR FAIRING ACCENT LIGHT KIT

IMPORTANT! No two installation scenarios are the same. Accent lighting is highly subjective. Not everyone shares the same lighting or installation quality goals. Some folks are OK with twisting wires together, others want to solder and heat shrink them. Some folks are OK with running wires where they may be seen or unprotected to save money/time, others want a tidy, clean install so they wrap plastic split-loom around all exposed cables. Some folks are OK with mounting their LED strips to whatever surface they can find, others want to take the time necessary to build out appropriate mounting surfaces to provide the best lighting effect on their vehicle and maximize the longevity of their lighting system. The point is it's not possible to provide all the materials necessary for all installation scenarios on all types of vehicles to meet everyone's quality goals. Our light kits provide the essential components needed for a high-quality, functioning lighting system. Installation of our light kit to your specific vehicle will however likely require additional items to make it look, fit and work the way you want. This is particularly the case with electrical wiring, switching functionality and mounting surfaces for the LED strips. We have created a list of additional items you may need. Here's the link: <https://www.boogeylights.com/other-items-you-might-need/> . While we offer them for sale you can also find these items locally. We urge you to review this information before starting your install.

BENCH TEST YOUR LIGHTING COMPONENTS FIRST!

We know this takes a few extra minutes, but we STRONGLY suggest you bench test your lights AND your controller / switches on a table before doing anything further. Test all of them. While we test every light strip and controller before shipping, bench testing your lights will eliminate the possibility of any problems with the lights or controller before mounting. It also lets you know everything is working properly. Also, the process of bench testing gives you an opportunity to understand the wiring system without interference from other wires, connectors and cables. You can use any 12vdc battery to do this (e.g. car battery, motorcycle battery, lawn tractor battery or 12vdc power supply). If you're not sure how to bench test, download this pdf: <https://docs.boogeylights.net/?wpdmdl=1305> . Bench testing takes an extra 10 or 15 minutes. It's simple to do and can potentially save you hours of time and frustration down the road.

Did we mention the importance of bench testing every LED strip and controller first?

THIS IS A GUIDE. NOT A HOW-TO. It's simply not possible to provide detailed instructions for all installation scenarios. Far too many variables. The information in this document is intended to be used as a guide. It is not a detailed step-by-step how-to installation manual. We do not spell out every single step along the way. We cover the essential steps related to installing this kit. Beyond that we assume the installer has the skills, knowledge and tools necessary to do the work using the information we provide as a guide. You may need to vary your installation and/or make adjustments based on your vehicle. This is particularly the case with led strip mounting locations, electrical wire routing, electrical connections, electrical load sizing and switching. If you're unsure about how to do the installation – particularly the electrical components – we urge you to seek assistance from someone who has those skills.

YOU MUST HAVE AN UNDERSTANDING OF 12V POWER. An essential skill with installation of any Boogey Lights LED products is knowing how to correctly wire the product to a 12vdc circuit. This includes understanding the importance of having a properly sized fuse at the power source, polarity, how to properly seal an electrical connection, using properly sized wire gauge for the load, measuring voltage and measuring the additional amperage draw you're adding. If you are uncertain or unfamiliar with any of these concepts, we urge you to ask someone who has the knowledge to assist you. Electricity is unforgiving.

MOUNTING SURFACE. How and where you mount your LED strips will for the most part determine the longevity of your lighting system. If you mount the LED strips to smooth, clean, continuous, straight, flat surfaces as we recommend, you can expect your lighting system to last for many years

SECURE THE POWER LEADS. Make sure the power lead wire that connects to one end of the LED strip is firmly secured to the boat. Do not allow that power lead to move or flex at the point where it attaches to the LED strip. If you do, it will fail prematurely and is not covered under warranty. All of the power leads coming from the LED strips will need to be routed back to your power source/switch/controller which is usually mounted near the battery bank. We typically will mount the led controller in the driver's side storage box (aka 'jockey box'). If you're installing this kit along with another one of our light kits, you can usually merge the wiring together. It's important these power lead be secured (especially at the point where the power lead attaches to the LED strip) and wrapped in split loom to prevent chafing.

INSTALLATION TIME. Installation of this light kit takes 2 to 5 hours depending on whether or not you're adding in the optional TAIL-TURN-BRAKE light integration and/or integrating with an existing Boogey Lights LED controller and light system from our Under-Glow or Under-Cab light system. We have included some photos later on in this guide to help you better understand how the lighting system is mounted. The first step in the installation process is to build out the mounting surface where the LED strips will be mounted. **Do not mount the LED strips directly to the plastic fairing extensions.** If you do, the LED strips will fail pre-maturely; which is not covered under warranty. Those plastic fairing extensions twist and flex way too much particularly when air flows over them at highway speeds. Instead, rivet the included black plastic molding to each of the four fairing extensions on the truck.

REAR FARING ACCENT (RFA) LIGHTS

There are 10 mounting locations. Five heavy duty LED strips on each side of the truck along the end of the fairing facing inward toward the back of the sleeper/cab. The first step is to rivet the included black plastic flat bar to each of the four fairing extensions on the truck. Our kit includes the 5/16" rivets to do this. The accent LED light strips mount to the inside of each of the plastic flat bar facing inward toward the rear of the cab. Be sure to install the reinforcing braces too referenced earlier in this documentation (see video link). If you're installing an LED controller or switch with this kit, you'll need to remove the driver's side steps to access the batteries (all power connections come from the battery directly). Also, the LED controller can be mounted in either the driver's side storage / jockey box or passenger's side. We prefer the driver's side since it's closest to the battery bank. Regardless of which side you choose, you will need to drill a hole in the floor of that box to connect power to the battery box, led wires and antenna. The 12vdc positive side of the LED controller will connect directly to the battery bank (with fuse). The 12vdc negative side will connect to any bare metal support. If you're also installing the tail/turn/brake light kit, those RED Heavy Duty led strips will mount to the same plastic flat bar pieces but facing toward the rear of the truck. All power leads run down the fairing and from there will connect to the switching device (e.g. LED controller, on/off switch) and/or the brake / tail / turn integration point which we like to do behind the cab area for easy access.

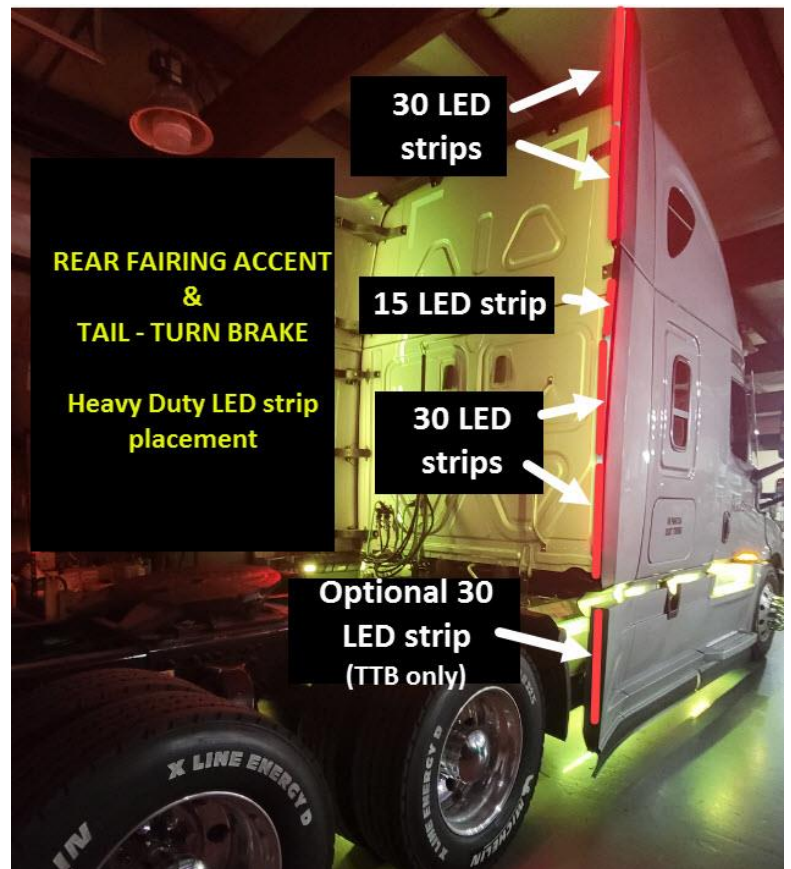

OPTIONAL TAIL / TURN / BRAKE ADD-ON

There are 10 mounting locations. Five heavy duty LED strips on each side of the truck along the end of the fairing facing rear-ward. See diagram of this layout further on this guide. The RED Tail / Turn / Brake LED light strips mount to the outside of each of the plastic flat bar facing toward the rear of the truck. The power leads from these LED strips run down the fairing and from there will connect to the relay housing which we suggest locating immediately behind the cab or similar location where the relay housing can be accessed if needed. A 10 awg battery cable needs to be run to the truck's battery and connected to the 12vdc + power with the included fuse holder. The 12vdc - needs to be connected to the frame.

For integration with the truck's tail-turn-brake lights to make the system work you need access to THREE circuits: the truck's tail light circuit, left turn signal and right turn signal. The truck's brake light uses the same light as the turn signals. Where you pull those circuits from is up to you HOWEVER we prefer to pull them directly from the rear tail light assembly on the rear the truck and then run a feeder cable up to the relay housing where the connections are made. We think it's easier (and cleaner) to do it this way while minimizing the possibility you might interfere with any of the truck's

other electrical systems (which is always a concern in these situations). The reality however is that you can also find these wires in the wiring harness that runs on the inside of the frame rails back to the rear tail light assembly. On the frame (aka 'chassis') ground, it's super important to make sure the surface you're connecting to is bare metal. In many cases you'll have to grind off the painted surface first. Refer to the RELAY wiring diagram at the end of the guide.

NOTE: You must use the three 40amp RELAYS we provide in the kit. Do not attempt to run the Boogey Lights tail/turn/brake light system using the truck's own lighting system power. Doing so will over-load the truck's LCM which will cause all of the lights on the truck to shut down. When that happens, you won't have any lights at all.

LED PLACEMENT

Once you have the black plastic flat bar riveted to the fairing it's time to mount the LED strips to that molding. The LED accent light strips face inward toward the back of the cab. These LEDs will flood the rear of the truck with light WITHOUT the LEDs themselves being seen by drivers on either side of the truck. If you're installing the RED tail/turn/brake light LED strips, those strips face rear-ward as shown in the photo.

The inward facing accent lighting LED power leads will connect to the Boogey Lights LED controller (assuming RGB installation) ... OR ... if this is a single color installation, those power leads will connect to whatever switch you're using to turn them on/off.

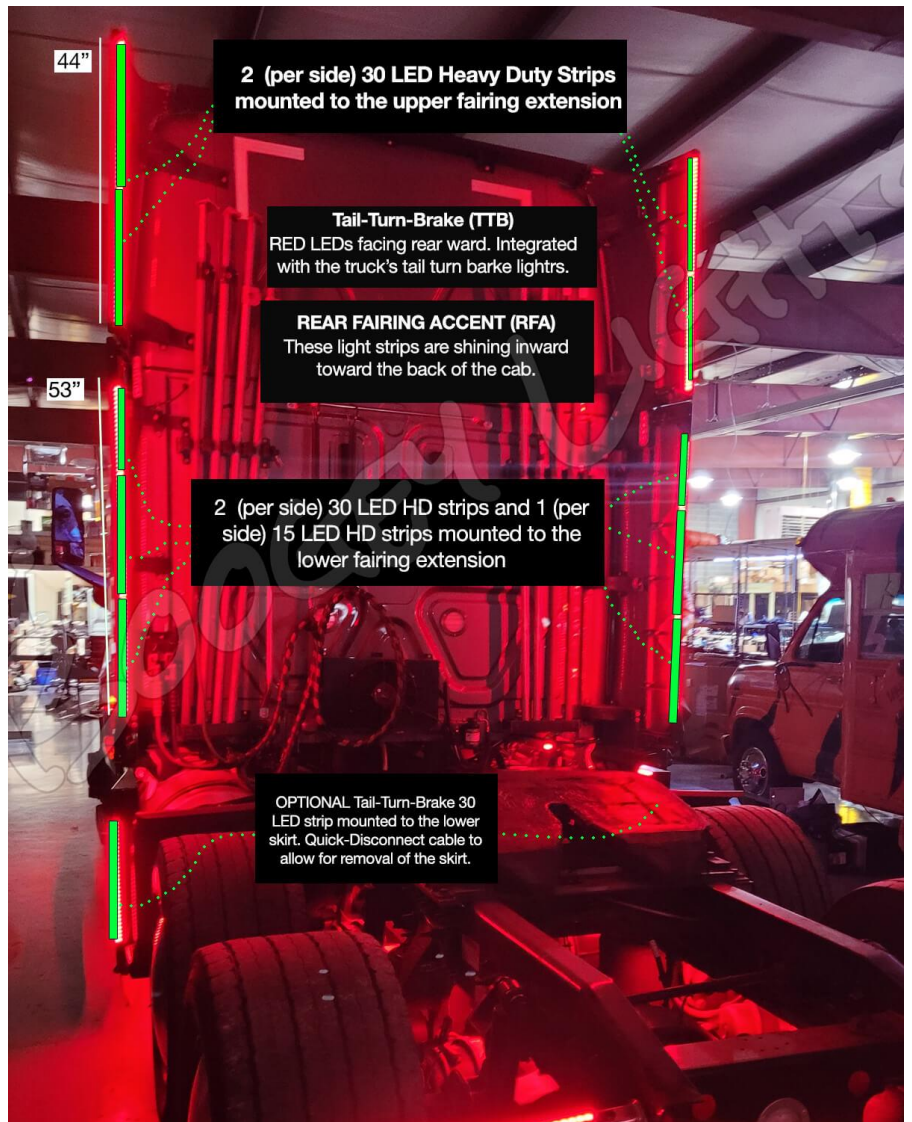

OPTIONAL TAIL / TURN / BRAKE LIGHT INTEGRATION

If you purchased the optional TAIL/TURN/BRAKE Light integration, there are three wiring diagrams at the end of this guide you'll need to complete the installation. The power leads from these LED strips run down the fairing and from there will connect to the relay housing which we suggest locating immediately behind the cab or similar location where the relay housing can be accessed if needed. A 10 awg battery cable needs to be run to the truck's battery and connected to the 12vdc + power with the included fuse holder. The 12vdc - needs to be connected to the frame.

For integration with the truck's tail-turn-break lights to make the system work, you need access to THREE circuits: the truck's tail light circuit, left turn signal and right turn signal. The truck's brake light uses the same light as the turn signals. Where you pull those circuits from is up to you HOWEVER we prefer to pull them directly from the rear tail light assembly on the rear the truck and then run a feeder cable up to the relay housing where the connections are made. We think it's easier (and cleaner) to do it this way while minimizing the possibility you might interfere with any of the truck's other electrical systems (which is always a concern in these situations). The reality however is that you can also find these wires in the wiring harness that runs on the inside of the frame rails back to the rear tail light assembly. On the frame (aka 'chassis') ground, it's super important to make sure the surface you're connecting to is bare metal. In many cases you'll have grind off the painted surface first. Refer to the RELAY wiring diagram at the end of the guide.

Follow these steps for mounting your LED strips:

- The area where you are mounting the LEDs has to be clean: free of all dirt, oil or anything that might affect the LED from sticking. You only get one opportunity to mount the LEDs so it's critical the area be prepared properly.
- Use alcohol to clean the area where you are going to mount the LED strip. Be sure to let the alcohol dry completely before proceeding to the next step. (Note: Do not use acetone or similar cleaner).
- Next, use the 3M Adhesion Promoter supplied with your kit to "paint" on the promoter where you are going to mount the LED strip. ***This is an important step. Do not bypass.*** Allow the promoter to dry for 60-90 seconds.
- Peel off the red backing tape that protects the 3M adhesive tape on your LED strip. Be careful not to let the tape touch anything. The 3M backing tape on these LED strips are one-use only. They cannot be reused.
- Carefully push the LED strip to the area you have prepared. You will want to apply only enough pressure to the strip to make sure it is firmly mounted. *You only get one opportunity to do this.* Once the LED strip touches a properly prepared surface that has been promoted, that LED strip will be very difficult to remove. Moreover, if you do remove the LED strip, the strip cannot be used again without adding another layer of 3M adhesive tape to the back. **DO NOT press too hard as too much pressure can damage the LEDs and connecting wires in the strip. Also, do not pull, stretch or twist the LED strip. Too much tension on the strip will also damage the LEDs such that some of the LEDs in the strip will not illuminate. The strip must be mounted flat against a single continuous mounting surface, in a straight line. Really important that the ENTIRE STRIP be stuck to the mounting surface and that you NOT attempt to span across multiple mounting surfaces.**

Do NOT bend the LED strip in a radius of less than 2 inches.



Do NOT bend the LED strip on a horizontal plane.



INSTALLATION PHOTOS

Here are some photos with comments on the installation we did in building this kit. We've commented on key parts of the installation along the way.

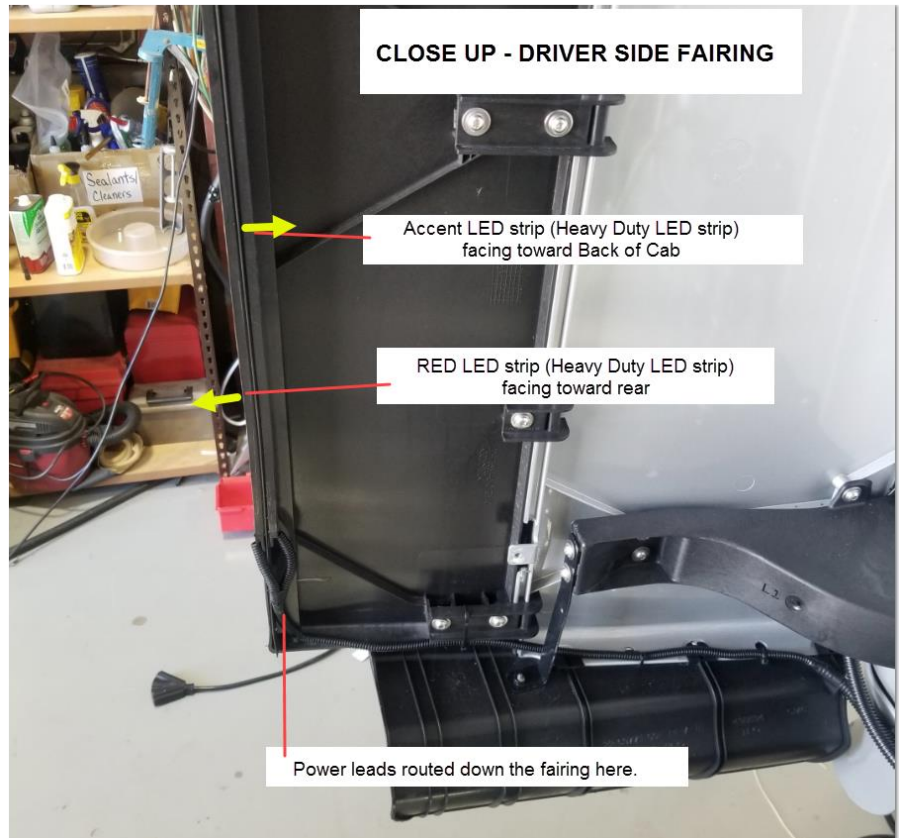

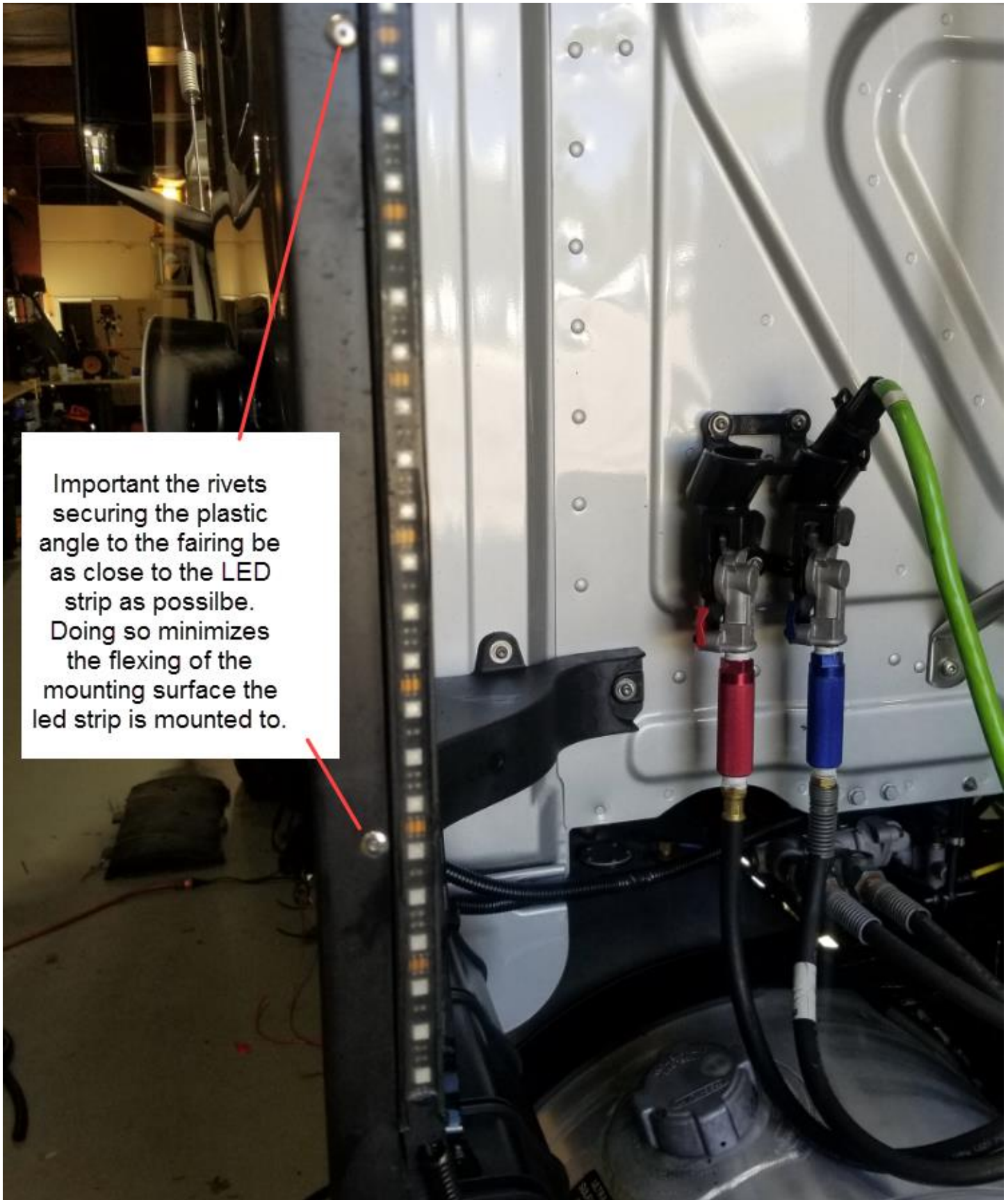

Important the rivets securing the plastic angle to the fairing be as close to the LED strip as possible. Doing so minimizes the flexing of the mounting surface the led strip is mounted to.

TAIL / TURN / BRAKE LIGHT INTEGRATION

If you purchased the optional TAIL/TURN/BRAKE Light integration, these two diagrams show you how the LED strips need to be wired. **NOTE: You must use the RELAYS we provide. Do not attempt to run the Boogey Lights tail/turn/brake light system using the truck's own lighting system power. Doing so will over-load the truck's LCM which will cause all of the lights on the truck to shut down. When that happens, you won't have any lights at all.**

Note: Starting May 1, 2023 the L1 and R1 LED segments shown in the photo below consist of TWO Heavy Duty LED strips instead of one. Starting October 1, 2023 the L2 and R2 LED segments shown in this photo have THREE LED strips instead of one (2 – 30 LED strips and 1 – 15 LED strip on each side). See layout diagram earlier on in this guide.

TAIL-TURN-BRAKE RELAY WIRING

BOOGEE LIGHTS

LED STRIP

LEFT SIDE power leads
coming from L1 & L2



BLACK = chasis ground
BLUE (diode 1) -> RELAY 2
GREEN (diode 2) -> RELAY 1
RED (diode 3) -> RELAY 1

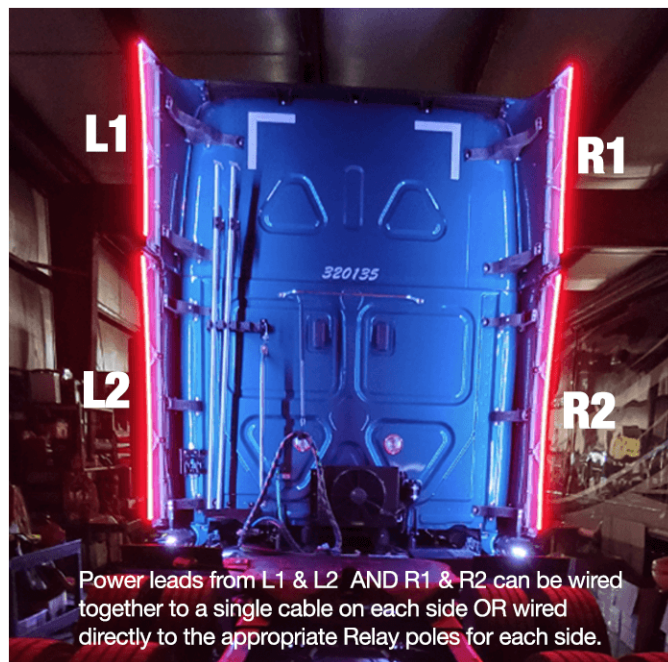

BOOGEE LIGHTS

LED STRIP

RIGHT SIDE power leads
coming from R1 & R2



BLACK = chasis ground
BLUE (diode 1) -> RELAY 2
GREEN (diode 2) -> RELAY 3
RED (diode 3) -> RELAY 3



TAIL-TURN-BRAKE RELAY WIRING

RELAY 1

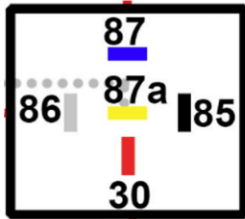

view of bottom of relay
each pole is numbered

85: Frame ground.

86: 12vdc+ trigger wire INPUT
from truck's LEFT turn signal.

87: 12vdc+ OUT to Diodes 2 and
3 on the LEFT SIDE Boogey
Lights LED STRIP.

87a: not used. cap the wire

30: Connects to 12vdc+ side of
battery (with inline fuse).

RELAY 2

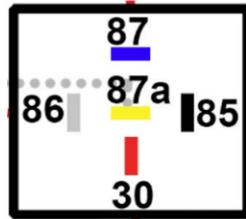

view of bottom of relay
each pole is numbered

85: Frame ground.

86: 12vdc+ trigger wire INPUT
from truck's TAIL LIGHT aka
Running Lights.

87: 12vdc+ OUT to Diode 1 on
BOTH the LEFT and RIGHT SIDE
Boogey Lights LED STRIPS

87a: not used. cap the wire

30: Connects to 12vdc+ side of
battery (with inline fuse).

RELAY 3

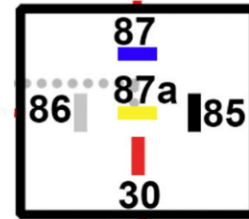

view of bottom of relay
each pole is numbered

85: Frame ground.

86: 12vdc+ trigger wire INPUT
from truck's RIGHT turn signal.

87: 12vdc+ OUT to Diodes 2 and
3 on the RIGHT SIDE Boogey
Lights LED STRIP.

87a: not used. cap the wire

30: Connects to 12vdc+ side of
battery (with inline fuse).



View of the 3 relays in the water proof housing.

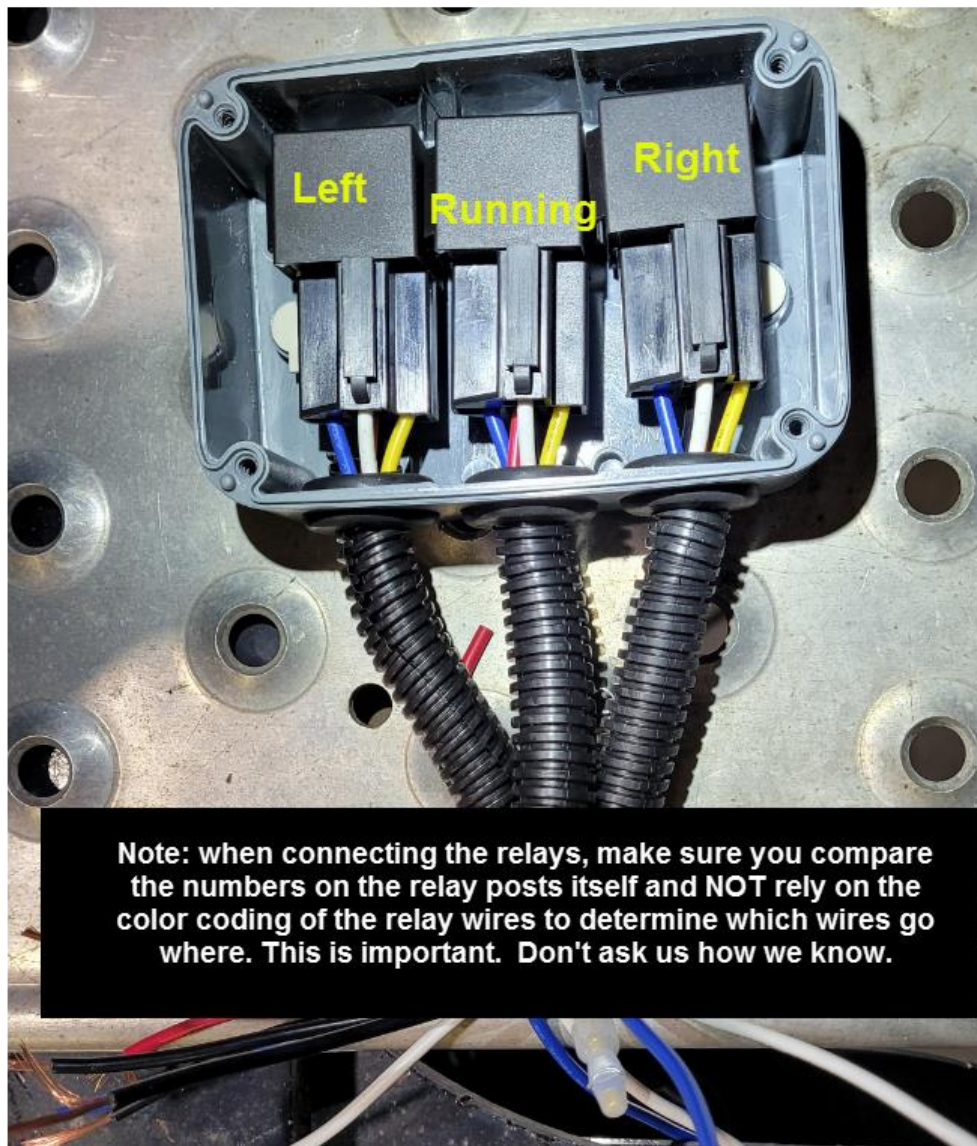

Be sure the RELAYS are mounted in the provided housing OR something similar to keep them dry.

This product does not include any quick disconnect connectors. However, you will need to extend the power leads on the Heavy Duty LED strips if you purchased the Tail Turn Brake light integration. The below diagram shows you how we use the heat shrink to make these power lead connections.

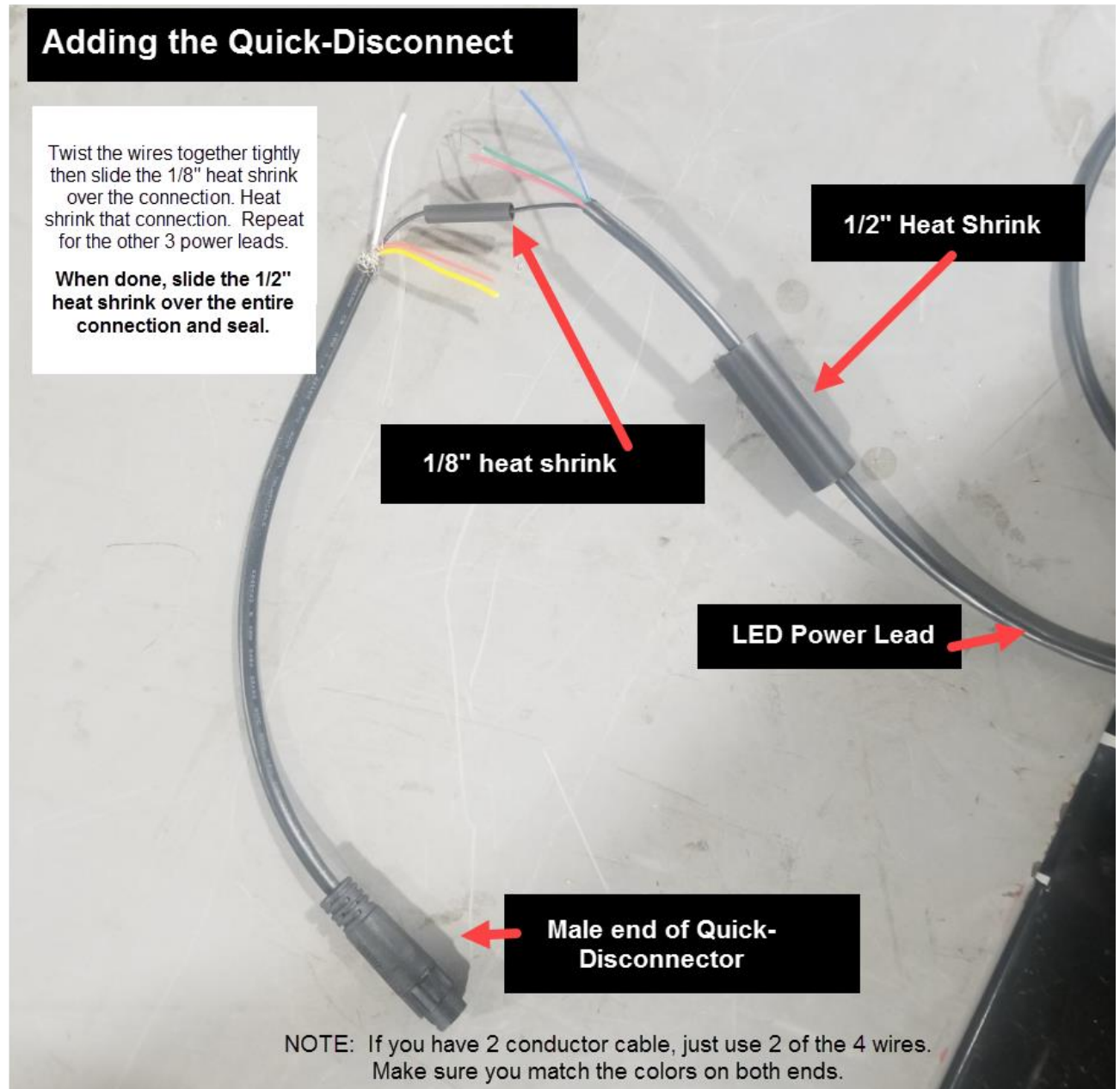

Additional Resources

- Product Page: <https://www.boogeylights.com/volvo-vnl-led-accent-light-kit/>
- How to Videos: <https://www.boogeylights.com/how-to-videos/>
- Troubleshooting: <https://www.boogeylights.com/trouble-shooting-guide/>
- Installation Resources: <https://www.boogeylights.com/installation-resources/>
- How to Bench Test: <https://docs.boogeylights.net/?wpdmdl=1305>
- Amperage Data: <https://docs.boogeylights.net/?wpdmdl=1137>
- Cutting Your LEDs: <https://docs.boogeylights.net/?wpdmdl=964>
- GEN2 LED Controller Wiring Diagrams + Operating Info: <https://docs.boogeylights.net/?wpdmdl=1163>
- GEN2 RF Wireless Remote Operating Info: <https://docs.boogeylights.net/?wpdmdl=1164>
- GEN2 Bluetooth APP Operating Info: <https://docs.boogeylights.net/?wpdmdl=1169>
- GEN2 Bluetooth APP Quick-Start: <https://docs.boogeylights.net/?wpdmdl=1167>

Support

- Phone: 800.847.1359 (M-F, 9-6 Eastern)
- Text: 859.955.8155
- Open a Support Ticket: <https://www.boogeylights.com/email-us/>
- Online: 24/7 resources at <https://www.boogeylights.com/installation-resources/>
- How to Make a Warranty Claim: <https://www.boogeylights.com/make-a-warranty-claim/>

Warranty

The Boogey Lights® warranty requires an original sales receipt from Boogey Lights or an authorized dealer. It covers product replacement only, not labor or other costs. Register your purchase at: <https://www.boogeylights.com/warranty-registration/>. Full details: <https://www.boogeylights.com/warranty/>.