



INSTALLATION GUIDE

MACK ANTHEM REAR FAIRING ACCENT LED LIGHT KIT

IMPORTANT! No two installation scenarios are the same. Accent lighting is highly subjective. Not everyone shares the same lighting or installation quality goals. Some folks are OK with twisting wires together, others want to solder and heat shrink them. Some folks are OK with running wires where they may be seen or unprotected to save money/time, others want a tidy, clean install so they wrap plastic split-loom around all exposed cables. Some folks are OK with mounting their LED strips to whatever surface they can find, others want to take the time necessary to build out appropriate mounting surfaces to provide the best lighting effect on their vehicle and maximize the longevity of their lighting system. The point is it's not possible to provide all the materials necessary for all installation scenarios on all types of vehicles to meet everyone's quality goals. Our light kits provide the essential components needed for a high-quality, functioning lighting system. Installation of our light kit to your specific vehicle will however likely require additional items to make it look, fit and work the way you want. This is particularly the case with electrical wiring, switching functionality and mounting surfaces for the LED strips. We have created a list of additional items you may need. Here's the link: <https://www.boogeylights.com/other-items-you-might-need/> . While we offer them for sale you can also find these items locally. We urge you to review this information before starting your install.

BENCH TEST YOUR LIGHTING COMPONENTS FIRST!

We know this takes a few extra minutes, but we **STRONGLY** suggest you bench test your lights AND your controller / switches on a table before doing anything further. Test all of them. While we test every light strip and controller before shipping, bench testing your lights will eliminate the possibility of any problems with the lights or controller before mounting. It also lets you know everything is working properly. Also, the process of bench testing gives you an opportunity to understand the wiring system without interference from other wires, connectors and cables. You can use any 12vdc battery to do this (e.g. car battery, motorcycle battery, lawn tractor battery or 12vdc power supply). If you're not sure how to bench test, download this pdf: <https://docs.boogeylights.net/?wpdmdl=1305> . Bench testing takes an extra 10 or 15 minutes. It's simple to do and can potentially save you hours of time and frustration down the road.

Did we mention the importance of bench testing every LED strip and controller first?

THIS IS A GUIDE. NOT A HOW-TO. It's simply not possible to provide detailed instructions for all installation scenarios. Far too many variables. The information in this document is intended to be used as a guide. It is not a detailed step-by-step how-to installation manual. We do not spell out every single step along the way. We cover the essential steps related to installing this kit. Beyond that we assume the installer has the skills, knowledge and tools necessary to do the work using the information we provide as a guide. You may need to vary your installation and/or make adjustments based on your vehicle. This is particularly the case with led strip mounting locations, electrical wire routing, electrical connections, electrical load sizing and switching. If you're unsure about how to do the installation – particularly the electrical components – we urge you to seek assistance from someone who has those skills.

YOU MUST HAVE AN UNDERSTANDING OF 12V POWER. An essential skill with installation of any Boogey Lights LED products is knowing how to correctly wire the product to a 12vdc circuit. This includes understanding the importance of having a properly sized fuse at the power source, polarity, how to properly seal an electrical connection, using properly sized wire gauge for the load, measuring voltage and measuring the additional amperage draw you're adding. If you are uncertain or unfamiliar with any of these concepts, we urge you to ask someone who has the knowledge to assist you. Electricity is unforgiving.

MOUNTING SURFACE. How and where you mount your LED strips will for the most part determine the longevity of your lighting system. If you mount the LED strips to smooth, clean, continuous, straight, flat surfaces as we recommend, you can expect your lighting system to last for many years

SECURE THE POWER LEADS. Make sure the power lead wire that connects to one end of the LED strip is firmly secured to the boat. Do not allow that power lead to move or flex at the point where it attaches to the LED strip. If you do, it will fail prematurely and is not covered under warranty.

POWER LEADS. All of the power leads coming from the LED strips will need to be routed back to your power source/switch/controller which is usually mounted near the battery bank. We typically will mount the led controller in the driver's side storage box (aka 'jockey box'). If you're installing this kit along with another one of our light kits, you can usually merge the wiring together. It's important these power lead be secured (especially at the point where the power lead attaches to the LED strip) and wrapped in split loom to prevent chafing.

Installation Time

Installation takes 2-4 hours depending on whether or not you're integrating with the Tail-Turn-Brake light kit and/or other Boogey Lights kits. Single color vs Multi-Color will also impact the time required to do this installation.

Mounting & Placement Locations | Planning Your Install

All the LED strips in the Rear Fairing Accent light kit are built on our low profile hi-intensity surface mounted LED strips. There are three low profile LED strips mounted on each side of the rear fairing; each of them facing in-ward toward the back of the cab. There are three different LED lengths (with power leads) that will fit on the inside of the aluminum fairing for each side. The shortest on top (15 LEDs – marked as segment A in our photo), the next shortest (39 LEDs - segment B) in the middle and the longest (81 LEDs – segment C) on the bottom. We have included a photo of the layout on the passenger's side fairing further down on this page showing the mounting of these three LED strips along with how the power leads are routed. You'll need to repeat the process for the driver's side.

For power, you'll need access to the driver's side steps to access the batteries. Also, if you're installing an LED controller, the LED controller can be mounted in either the driver's side storage box or the passenger's. We prefer to use the driver's side as it is closest to the battery bank. While either location will work, be aware if you mount the controller in the passenger's side, you'll need to extend the positive battery cable a little further than if you mounted the controller in the driver's side storage. The 12vdc + power going to the LED Controller should connect directly to the 12vdc+ terminal on your truck's battery bank. You can connect the ground wire on the LED controller to any metal part of the chassis. Regardless of which side bay you use, you will need to drill a hole in the floor of that box to connect power to the battery box, led wires and antenna.

We recommend planning out your install on paper first. Be sure to wrap all power leads in split-loom which is also included and then secure them to the truck using zip ties.

LED PLACEMENT

These are the LED placement locations we used for this kit. It's important to follow this placement pattern to ensure the LED strips are protected. Mounting them in any other way voids warranty.

Note LED segments D and E on this photo are for our optional Tail-Turn-Brake light integration. More details about that further along in this guide.

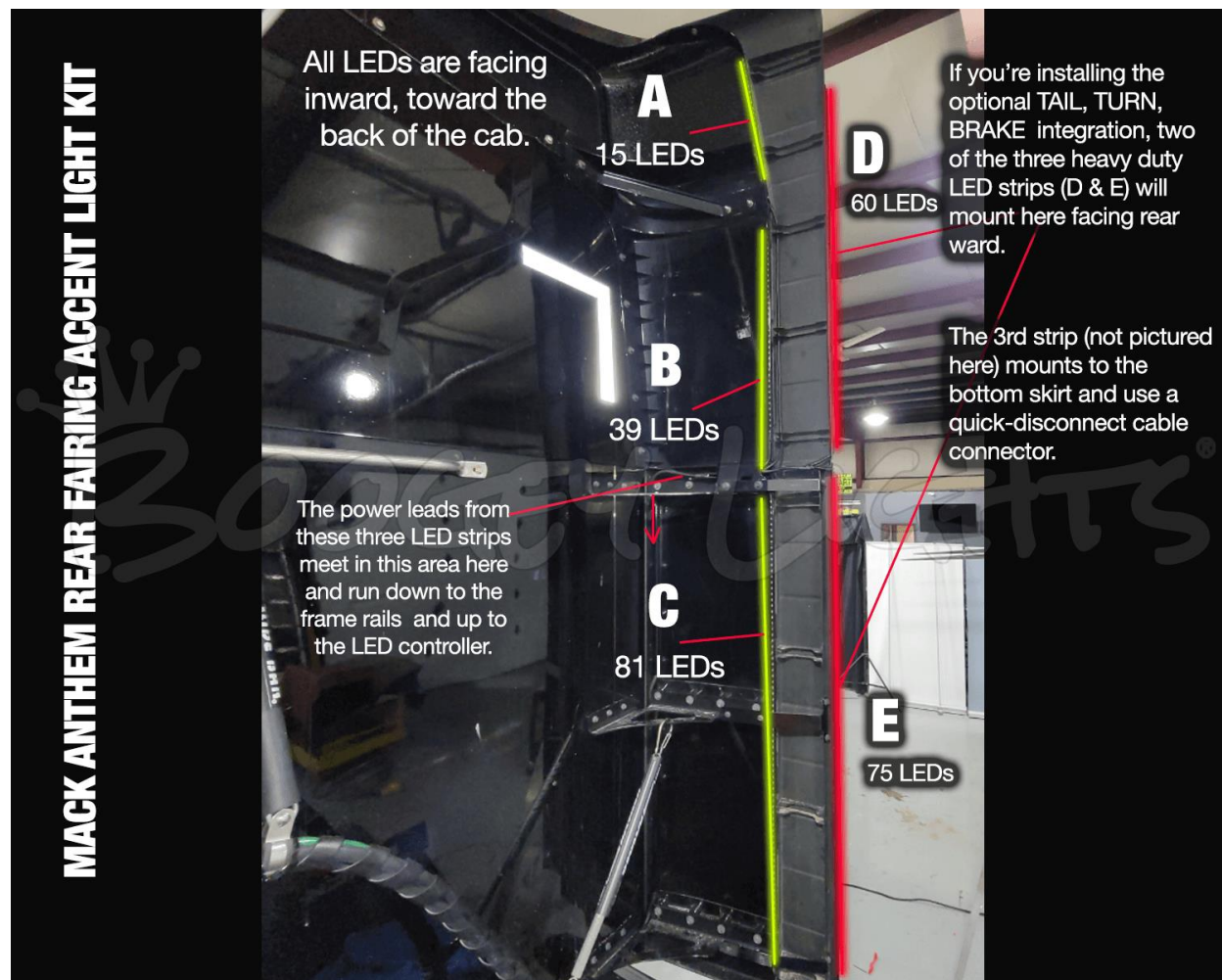

Here's a view of the Driver's side rear fairing mounting locations.

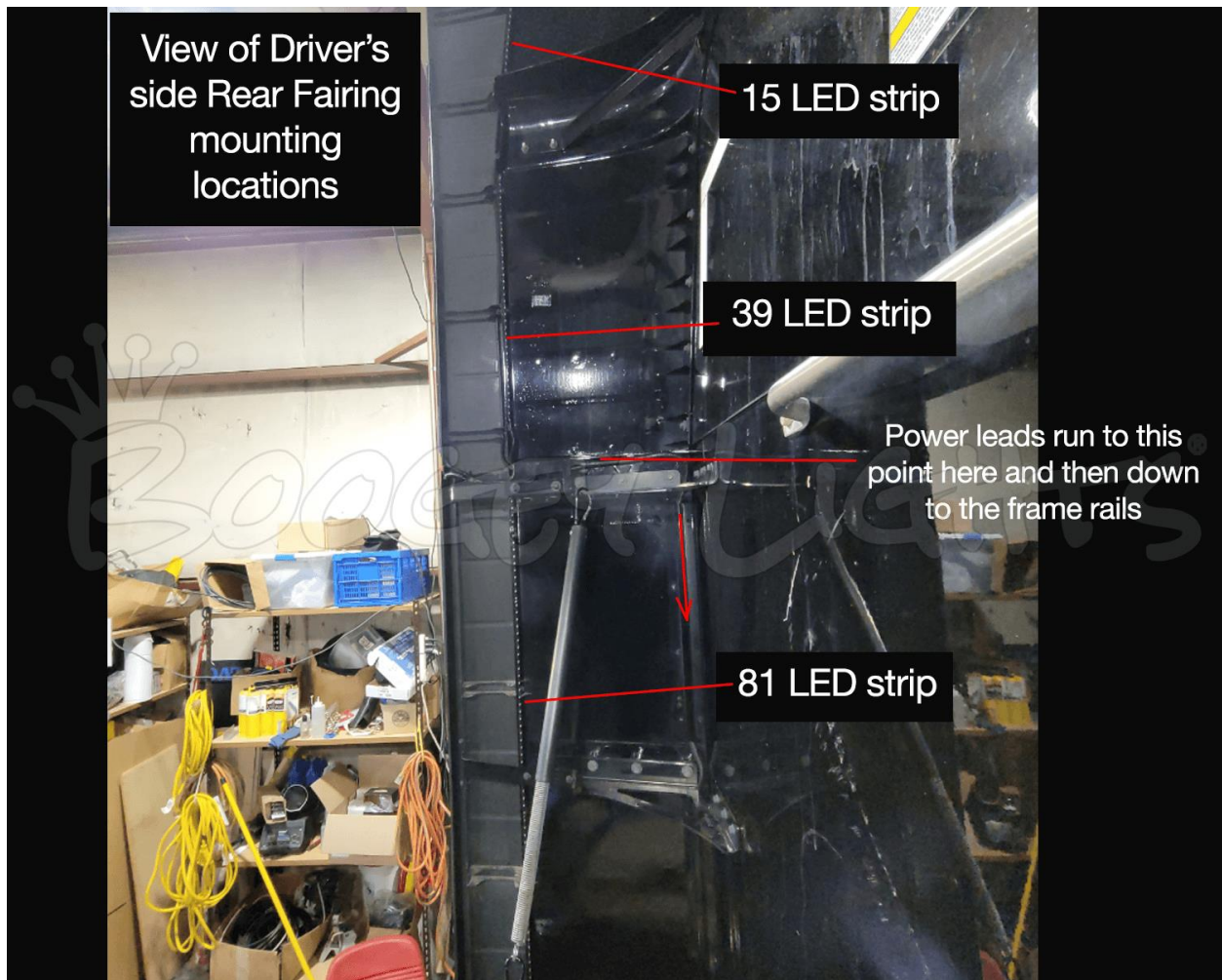

All of the power leads coming from the Rear Fairing Accent light leds will need to be routed up to the LED Controller (if RGB) or the switching mechanism you're using if single color. Be sure to wrap these power leads in split loom.

Tail – Turn – Brake

All of the LED strips in our Tail-Turn-Brake light kit are built on our Heavy Duty LED strips. There are three Heavy Duty LED strips (RED only) mounted on the leading edge of the plastic fairing extension of each side of the truck facing rearward. The two longest Heavy Duty LED strips are on that fairing extension (marked as segments D - 60 LEDs and E - 75 LEDs in the photo above). The shorter heavy duty LED strip (15 LEDs), mounts to the back side of the lower side skirt on each side of the truck. We install a quick-disconnect connector on that LED strip only since the side skirt may need to be removed for service at some point. We include both photos below of how we wire the tail-turn-brake system using a series of 3 relays.

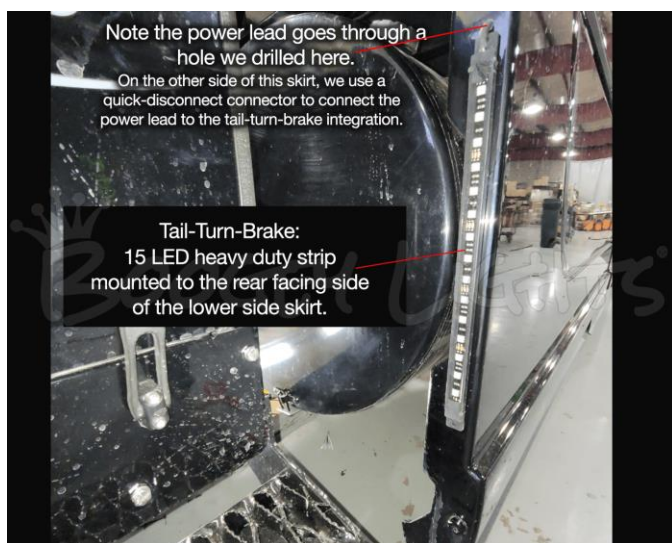
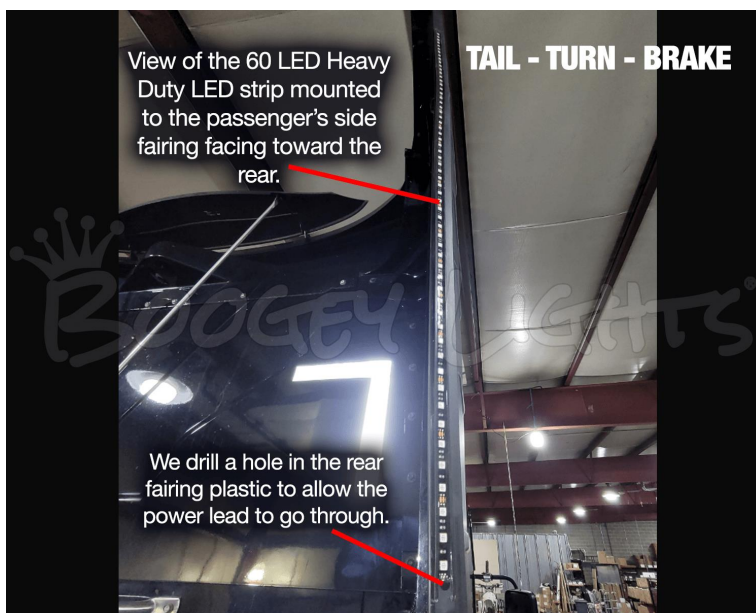

TAIL / TURN / BRAKE LIGHT INTEGRATION

For the MACK ANTHEM, there are THREE LED strips on each side (not 2 as shown here)

BOOGIE LIGHTS

LED STRIP

LEFT SIDE power leads coming from L1 & L2



BLACK = chasis ground
BLUE (diode 1) -> RELAY 2
GREEN (diode 2) -> RELAY 1
RED (diode 3) -> RELAY 1

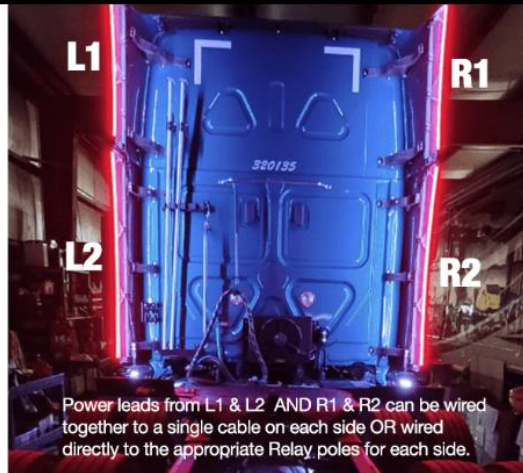

Power leads from L1 & L2 AND R1 & R2 can be wired together to a single cable on each side OR wired directly to the appropriate Relay poles for each side.

BOOGIE LIGHTS

LED STRIP

RIGHT SIDE power leads coming from R1 & R2



BLACK = chasis ground
BLUE (diode 1) -> RELAY 2
GREEN (diode 2) -> RELAY 3
RED (diode 3) -> RELAY 3

RELAY WIRING

RELAY 1

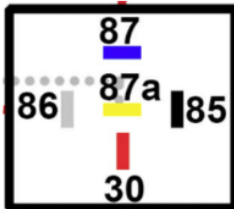

view of bottom of relay
each pole is numbered

85: Frame ground.

86: 12vdc+ trigger wire INPUT from truck's LEFT turn signal.

87: 12vdc+ OUT to Diodes 2 and 3 on the LEFT SIDE Boogey Lights LED STRIP.

87a: not used. cap the wire

30: Connects to 12vdc+ side of battery (with inline fuse).

RELAY 2

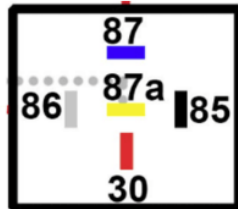

view of bottom of relay
each pole is numbered

85: Frame ground.

86: 12vdc+ trigger wire INPUT from truck's TAIL LIGHT aka Running Lights.

87: 12vdc+ OUT to Diode 1 on BOTH the LEFT and RIGHT SIDE Boogey Lights LED STRIPS

87a: not used. cap the wire

30: Connects to 12vdc+ side of battery (with inline fuse).

RELAY 3

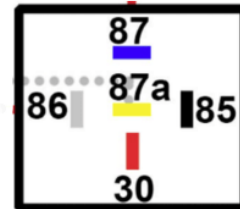

view of bottom of relay
each pole is numbered

85: Frame ground.

86: 12vdc+ trigger wire INPUT from truck's RIGHT turn signal.

87: 12vdc+ OUT to Diodes 2 and 3 on the RIGHT SIDE Boogey Lights LED STRIP.

87a: not used. cap the wire

30: Connects to 12vdc+ side of battery (with inline fuse).

View of the 3 relays in the water proof housing.

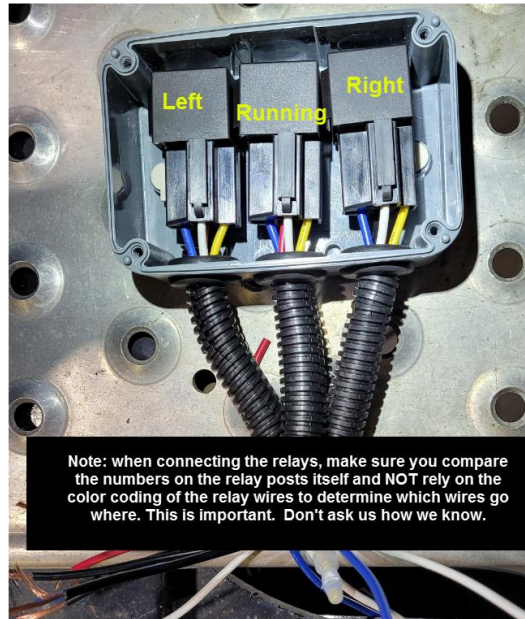

QUICK – DISCONNECTS

For the two 15 LED strips mounted on each of the lower side skirts you'll need to add a quick-disconnect connector in the circuit (included in the kit if the tail turn brake light option is ordered). This will allow the side skirts to be removed from the truck without having to cut the power lead cables going to each of the 15 LED strips mounted on each side. Below is a diagram of how we suggest making those connections using 1/8" and 1/2" heat shrink.

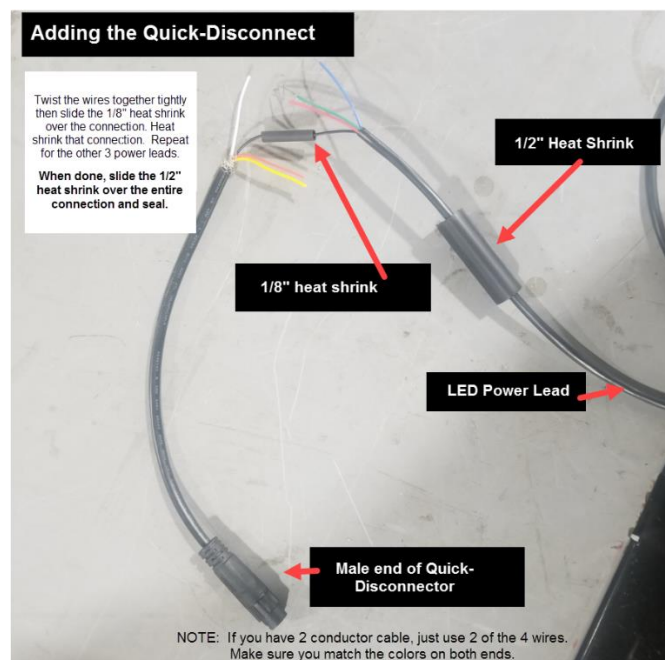

MOUNTING YOUR LED STRIPS

Follow these steps for mounting your LED strips:

- The area where you are mounting the LEDs has to be clean: free of all dirt, oil or anything that might affect the LED from sticking. You only get one opportunity to mount the LEDs so it's critical the area be prepared properly.
- Use rubbing alcohol to clean the area where you are going to mount the LED strip. Be sure to let the alcohol dry completely before proceeding to the next step. (Note: Do not use acetone or similar cleaner).

If the area is especially greasy, you'll need to clean it with a degreaser or similar solvent. IF you do, be sure to use rubbing alcohol on the surface next to completely remove any left-over residue from the degreaser.

Do NOT bend the LED strip in a radius of less than 2 inches.



- Next, use the 3M Adhesion Promoter supplied with your kit to "paint" on the promoter where you are going to mount the LED strip. ***This is an important step. Do not bypass.*** Allow the promoter to dry for 60-90 seconds.

Do NOT bend the LED strip on a horizontal plane.



- Peel off the red backing tape that protects the 3M adhesive tape on your LED strip. Be careful not to let the tape touch anything. The 3M backing tape on these LED strips are one-use only. They cannot be reused.

Carefully push the LED strip to the area you have prepared. You will want to apply only enough pressure to the strip to make sure it is firmly mounted. *You only get one opportunity to do this.* Once the LED strip touches a properly prepared surface that has been promoted, that LED strip will be very difficult to remove. Moreover, if you do remove the LED strip, the strip cannot be used again without adding another layer of 3M adhesive tape to the back. DO NOT press too hard as too much pressure can damage the LEDs and connecting wires in the strip. Also, do not pull, stretch or twist the LED strip. Too much tension on the strip will also damage the LEDs such that some of the LEDs in the strip will not illuminate. The strip must be mounted flat against a single continuous mounting surface, in a straight line. Really important that the ENTIRE STRIP be stuck to the mounting surface and that you NOT attempt to span across multiple mounting surfaces.

Additional Resources

- Product Page: <https://www.boogeylights.com/mack-anthem-led-accent-light-kit/>
- How to Videos: <https://www.boogeylights.com/how-to-videos/>
- Troubleshooting: <https://www.boogeylights.com/trouble-shooting-guide/>
- Installation Resources: <https://www.boogeylights.com/installation-resources/>
- How to Bench Test: <https://docs.boogeylights.net/?wpdmdl=1305>
- Amperage Data: <https://docs.boogeylights.net/?wpdmdl=1137>
- Cutting Your LEDs: <https://docs.boogeylights.net/?wpdmdl=964>
- GEN2 LED Controller Wiring Diagrams + Operating Info:
<https://docs.boogeylights.net/?wpdmdl=1163>
- GEN2 RF Wireless Remote Operating Info: <https://docs.boogeylights.net/?wpdmdl=1164>
- GEN2 Bluetooth APP Operating Info: <https://docs.boogeylights.net/?wpdmdl=1169>
- GEN2 Bluetooth APP Quick-Start: <https://docs.boogeylights.net/?wpdmdl=1167>

Support

- Phone: 800.847.1359 (M-F, 9-6 Eastern)
- Text: 859.955.8155
- Open a Support Ticket: <https://www.boogeylights.com/email-us/>
- Online: 24/7 resources at <https://www.boogeylights.com/installation-resources/>
- How to Make a Warranty Claim: <https://www.boogeylights.com/make-a-warranty-claim/>

Warranty

The Boogey Lights® warranty requires an original sales receipt from Boogey Lights or an authorized dealer. It covers product replacement only, not labor or other costs. Register your purchase at:

<https://www.boogeylights.com/warranty-registration/>. Full details:
<https://www.boogeylights.com/warranty/>.